

COLLAR DE EJE

WESTON[®]

TOOLS

- En acero galvanizado
- Número de piezas 1
- Con tornillo opresor
- País de origen China

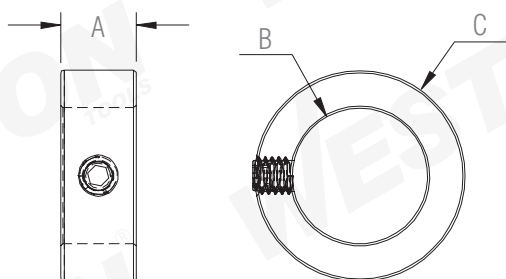

CÓDIGO	Ø INTERIOR (B)	Ø EXTERIOR (C)	ANCHO (A)	TORNILLO
A-19810	5/16"	5/8"	11/32"	#10-32 X 5/32"
A-19820	3/8"	3/4"	3/8"	1/4"-20 X 3/16"
A-19822	7/16"	7/8"	7/16"	1/4"-20" X 1/4"
A-19825	1/2"	1"	7/16"	1/4"-20 X 1/4"
A-19830	5/8"	1-1/8"	1/2"	5/16-18" X 1/4"
A-19835	3/4"	1-1/4"	9/16"	5/16-18" X 1/4"
A-19840	7/8"	1-1/2"	9/16"	5/16-18" X 5/16"
A-19845	1"	1-5/8"	5/8"	5/16-18" X 5/16"
A-19850	1-1/8"	1-3/4"	5/8"	5/16-18" X 5/16"
A-19855	1-3/16"	2"	11/16"	3/8-16" X 3/8"



EMPAQUE